



SOCKET WELD ENDS 套焊端
SCREWED ENDS 牙口端
FLANGED ENDS 法蘭端

DESIGN DESCRIPTION:

- Bolted Cover
- Lift Type

APPLICABLE STANDARDS:

- Design: API 602, BS 5352, JB/T 7746
- Flanged Ends: GB/T 9113, GB/T 9124.1
- Inspection and Test: API 598, GB/T 26480
- Face to Face: GB/T 12221
- Socket Weld Ends: ASME B 16.11
- Threaded Ends: ASME B 1.20.1
ISO 7-1, ISO 228-1

設計特性:

- 螺栓結合式閥蓋
- 升降式閥瓣(可加彈簧)

應用標準:

- 設計依據: API 602, BS 5352, JB/T 7746
- 法蘭接端: GB/T 9113, GB/T 9124.1
- 檢查和測試: API 598, GB/T 13927, GB/T 26480
- 法蘭結構長度: GB/T 12221
- 套焊端: ASME B 16.11
- 螺紋端: ASME B 1.20.1
ISO 7-1, ISO 228-1



PRESSURE TEST 壓力測試: GB/T 26480

bar

PRES RATING		SHELL TEST(WATER) 殼體水壓測試	SEATS TEST(WATER) 座部水壓測試	SEATS TEST(AIR) 座部氣壓測試
PN 壓力等級	Class 級數			
16	150#	32	22	6
50	300#	79	57	6
100	600#	156	114	6
130	800#	210	154	6

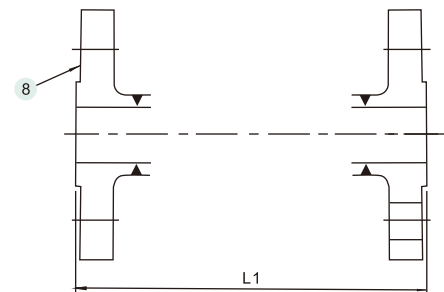

法蘭端間距

PARTS AND MATERIAL 主要零件材質(ASTM)

NO. 序號	PARTS NAME 零件名稱	MATERIALS 材質		
		A105碳鋼	F304不銹鋼	F316不銹鋼
1	Body 閥體	A105	A182-F304	A182-F316
2	Cover 閥蓋	A105	A182-F304	A182-F316
3	Disc 閥瓣	A276-410	A276-304	A276-316
4	Seat 閥座	A276-410+H/F STL#6	A276-304+H/F STL#6	A276-316+H/F STL#6
5	Gasket 墊圈	Graphite+ 304 Spiralwound	Graphite+ 304 Spiralwound	Graphite+ 316 Spiralwound
6	Cover Bolt 螺栓	A193-B7	A193-B8	A193-B8
7	Spring 彈簧	SUS304	SUS304	SUS316
8	Flange 法蘭端	A105	A182-F304	A182-F316

OTHER MATERIALS ARE AVAILABLE UPON REQUEST (可應需求, 供應其他材質.)

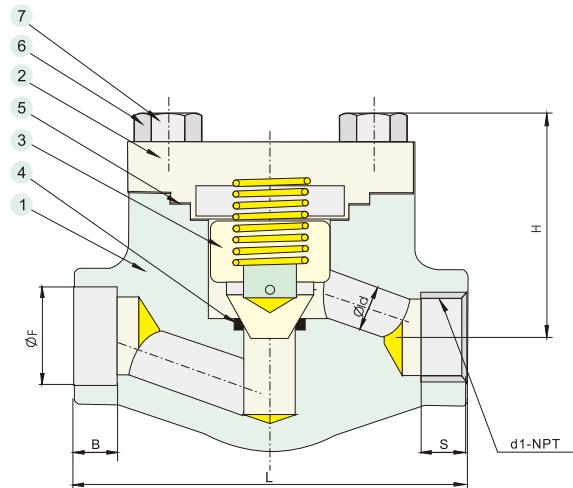

DIMENSION TABLE 主要尺寸: H61Y-800 LB

DN	NPS	d	L	L1			H	SOCKET WELD		SCREWD		WT.(kg) SW/NPT
				PN16	PN25/40	PN64/100		F	B	d1	S	
15	1/2	10	79	130	130	165	48	22	10	1/2"NPT	13.5	1.3
20	3/4	14	92	150	150	190	48	27	13	3/4"NPT	14.0	1.6
25	1	18	111	160	160	216	63	34	13	1"NPT	17.5	2.9
40	1-1/2	28	152	200	200	241	85	49	13	1-1/2"NPT	18.5	6
50	2	34	172	230	230	292	104	61	16	2"NPT	19.0	9.7